



Delivering Excellence, Building Solutions.

BUILDING IT BETTER IN CONCRETE



TH LINTEL





TH Lintel

TH Lintels are horizontal architectural member design for internal partition and load bearing walls. Offering cost effective solution for standard and heavy duty loads application caters for all loading conditions. Specially design to replace conventional concrete lintel.

Benefit :

- For use in solid walls
- Suitable for 100mm brick work
- Anti-Corrosion Protection System
- Light weight and Labour Saving
- Universal application caters for all loading conditions
- Various sizes available
- Speed Construction Time

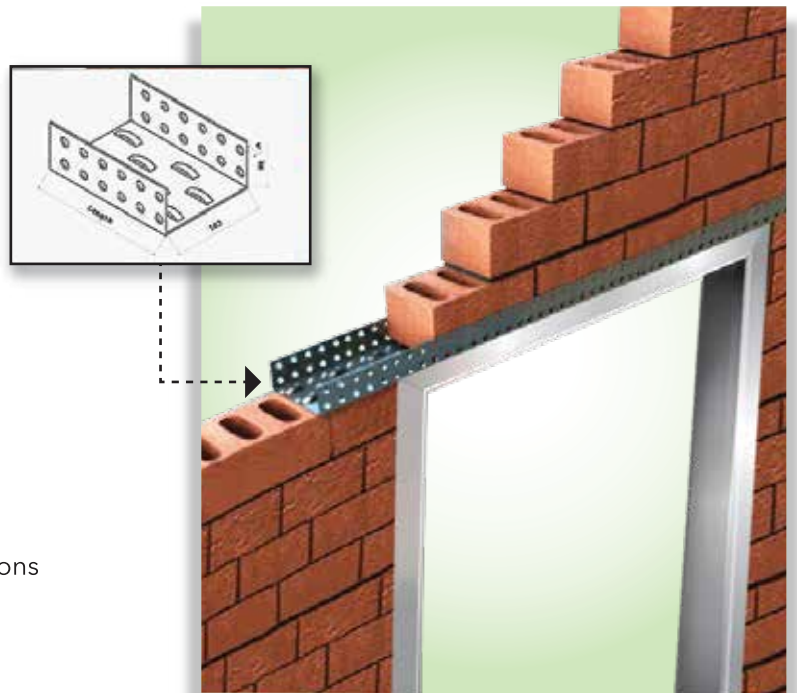

100mm Wall Width			
	THL 10016	THL 10020	THL 10025
Internal Width (mm)	115	115	115
Internal Flange (mm)	45	45	45
Material Thickness (mm)	1.6	2.0	2.5
Approx. Wight (Kg/m)	2.60	3.20	4.00

200mm Wall Width			
	THL 20016	THL 20020	THL 20025
Internal Width (mm)	215	215	215
Internal Flange (mm)	45	45	45
Material Thickness (mm)	1.6	2.0	2.5
Approx. Wight (Kg/m)	3.90	4.80	6.00

Lintel Installation Guide

Ensure lintel is level along its length

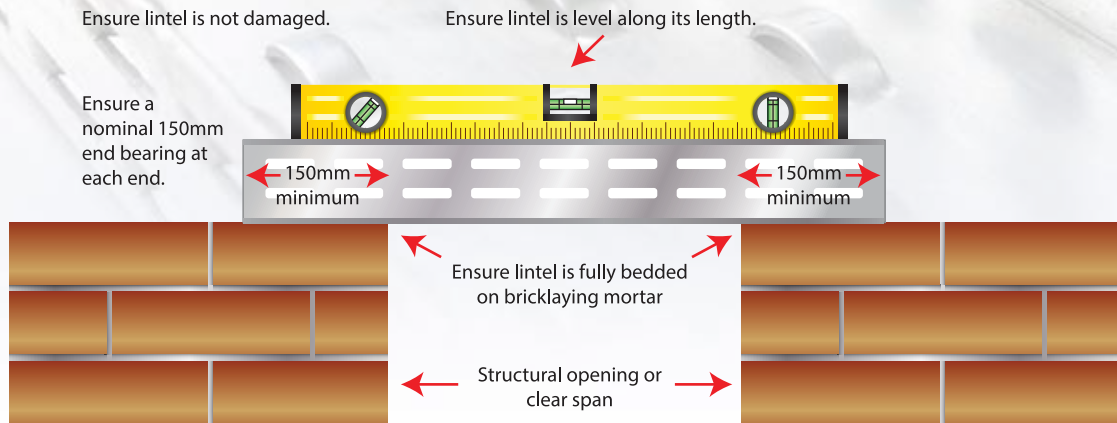

Ensure lintel is level along its width

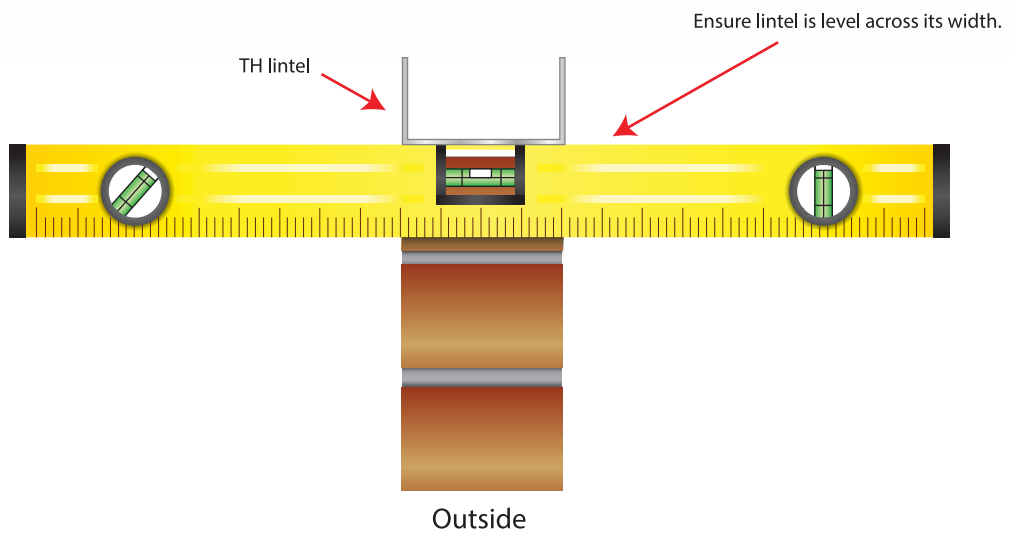

The length of the lintel

How wide is the structural opening?

1. Measure the size of the structural opening i.e. the clear span between the masonry supports.
2. Add 150mm minimum bearing to each end.

Example lintel length

$$= 150 + 1800 + 150$$

$$= 2100\text{mm length}$$

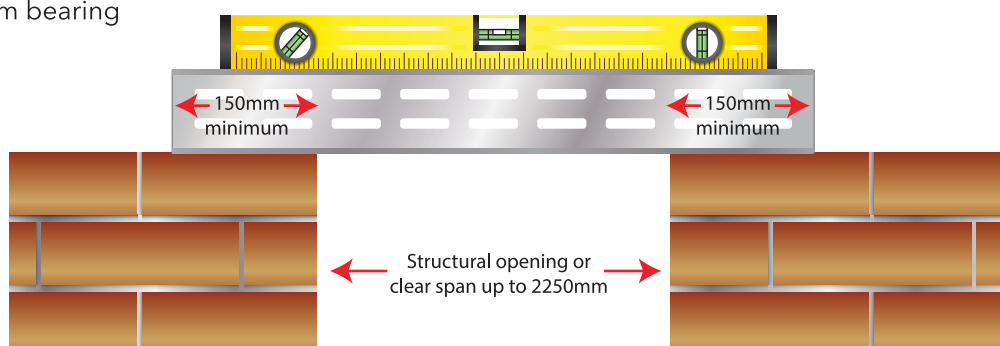

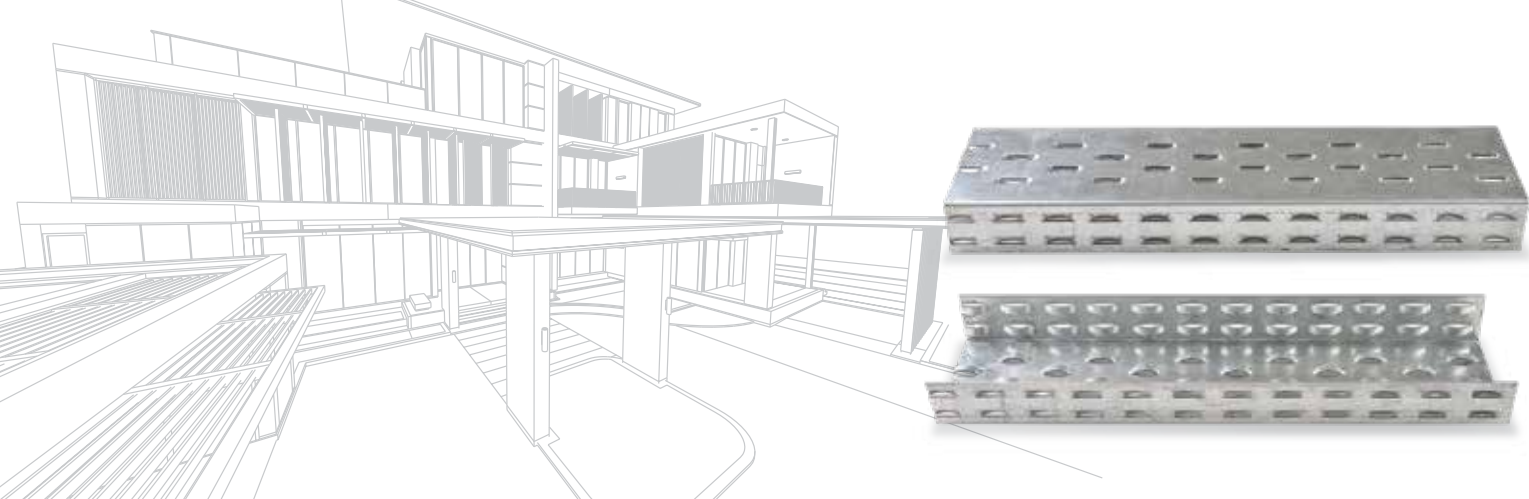

Test Report

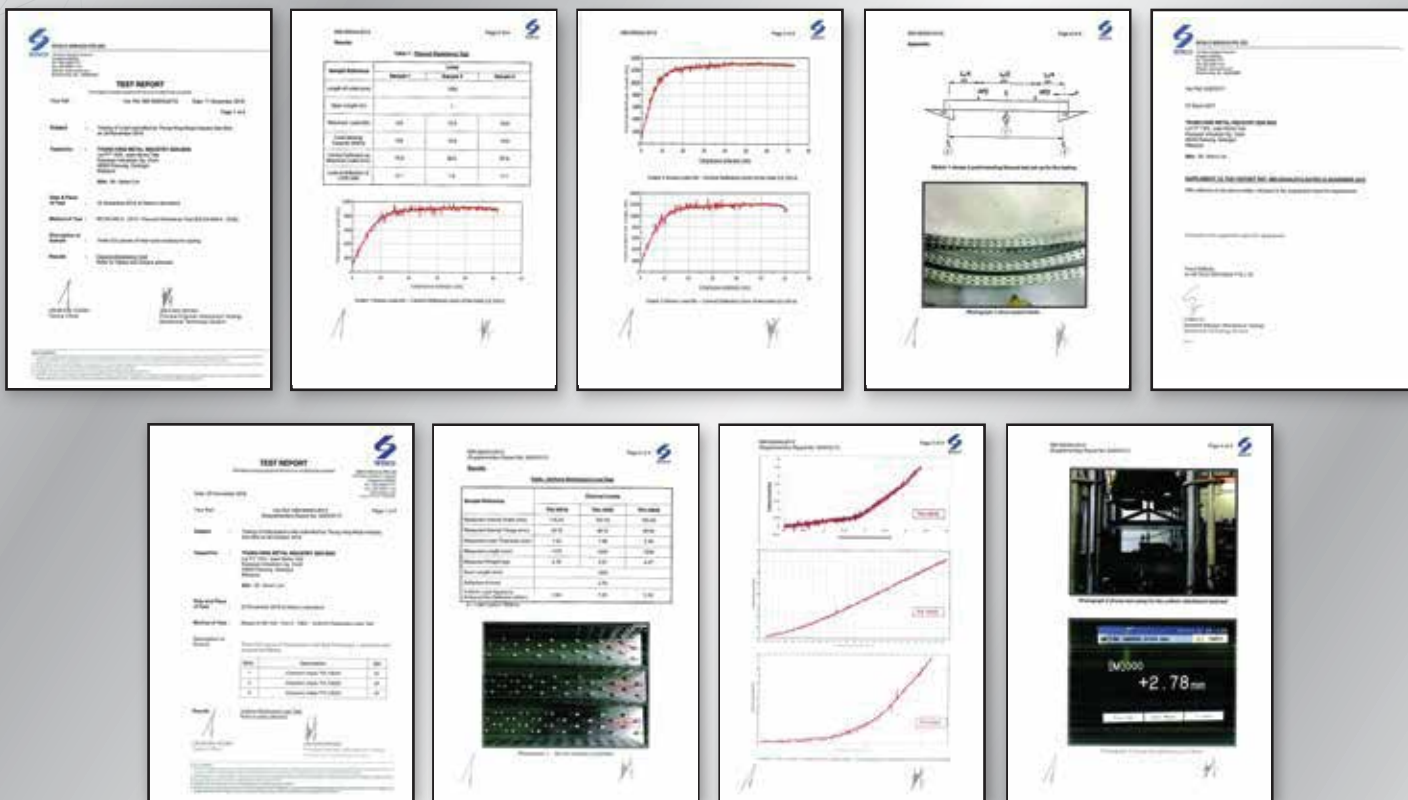

CENTRAL REGION

SELANGOR DARUL EHSAN :
 Lot P. T. 1353, Jalan Mohd Taib,
 Kaw. Industriarian Sg. Choh, 48000 Rawang,
 Selangor Darul Ehsan, Malaysia
 Tel : +603-6099 9999 / 9988
 Fax : +603-6099 9922 / 9933

NORTHERN REGION

KEDAH DARULAMAN :
 No. E2, Jalan Cendana 4/5,
 Kaw. Perindustrian Cendana,
 08000 Sungai Petani,
 Kedah Darul Aman, Malaysia
 Tel : +604-430 0321(HL)
 +604-430 4335 / 4568
 Fax : +604-430 4393 / 4348 / 4849
 H/P: +6012-381 9218

SOUTHERN REGION

JOHOR DARUL TAKZIM :
 Lot 4452, Pt. Kampung Abdul Rahman,
 82200 Benut, Pontian, Johor Darul Takzim,
 Malaysia
 Tel : +607-690 9926 / 9929
 H/P: +017 - 464 1218
 Fax : +607-690 9928

EAST COAST

KELANTAN DARUL NAIM :
 Lot 1493, Kaw. Perindustrian Pengkalan Chepa II,
 Seksyen 44, Mukim Panchor, Daerah Kemumin,
 16100 Kota Bharu, Kelantan Darul Naim, Malaysia
 Tel : +609-774 1127 / 1128
 H/P: +012 - 200 6335
 Fax : +609-609-774 1130 / 1131

THUNG HING METAL INDUSTRY SDN BHD (395096-D)

W www.thunghing.com.my E enquiries@thunghing.com



The information and illustration contained herein are for guidance only. Care has been taken to ensure all data and information herein is factual and numerical values are accurate at the time of publication. However, any or all technical specification, information and dimensions are nominal and provisional; they are subjected to change and variations in accordance with market conditions at the date of factual supply. No representation is made or to be implied as to the data and information herein; Thung Hing Metal Industry Sdn. Bhd. and its subsidiary and associate companies shall not be responsible for any errors in or misrepresentation of the information contained in this brochure or its use. Thung Hing Metal Industry Sdn. Bhd. and its subsidiary and associate companies reserve the right to alter any or all specifications as deemed fit and necessary without prior notice.
 Copyright © 2017 THUNG HING GROUP.